

DA 17K Tunnel Inlet

Technical Info



PRODUCT DESCRIPTION

The DA 17K tunnel inlet is used as an air inlet in houses with Tunnel-ventilation or Combi-Tunnel-ventilation.

The DA 17K tunnel inlet can be installed directly into interior walls or sandwich panels.

The DA 17K is available both with high-insulated inlet flaps made from PVC (polyvinylchlorid) fill up with insulation and with semi-insulated inlet flaps made from PVC (polyvinylchloride).

The inlet is delivered with the inlet flaps installed. The operation set is installed on-site.

Encroachment into the house is 370 mm.

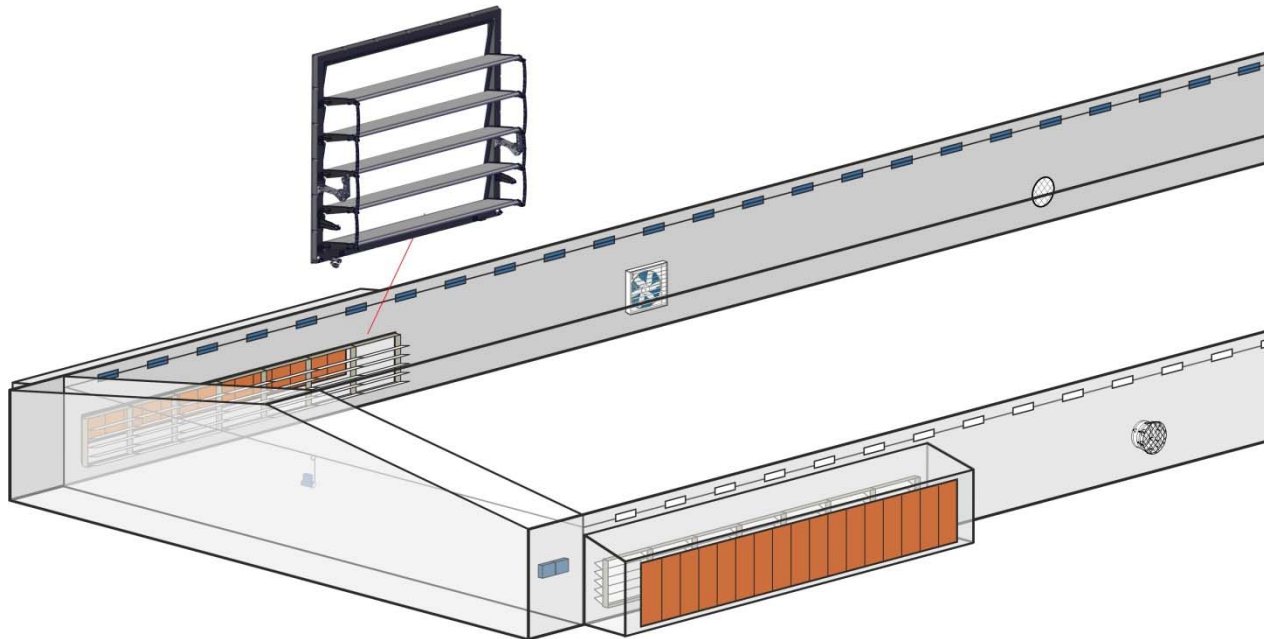

Figure 1: Drawing of DA 17K tunnel inlet, single row

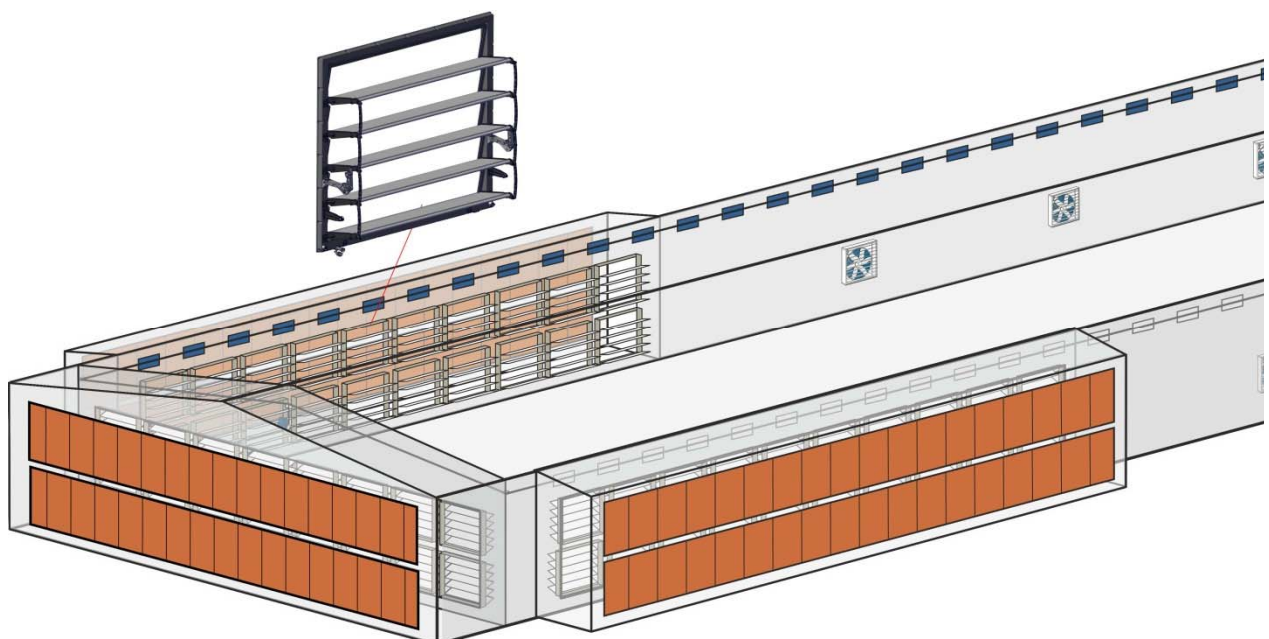

Figure 2: Drawing of DA 17K Tunnel inlet, double row

PRODUCT OVERVIEW

1 Overview drawing DA 17K tunnel inlet

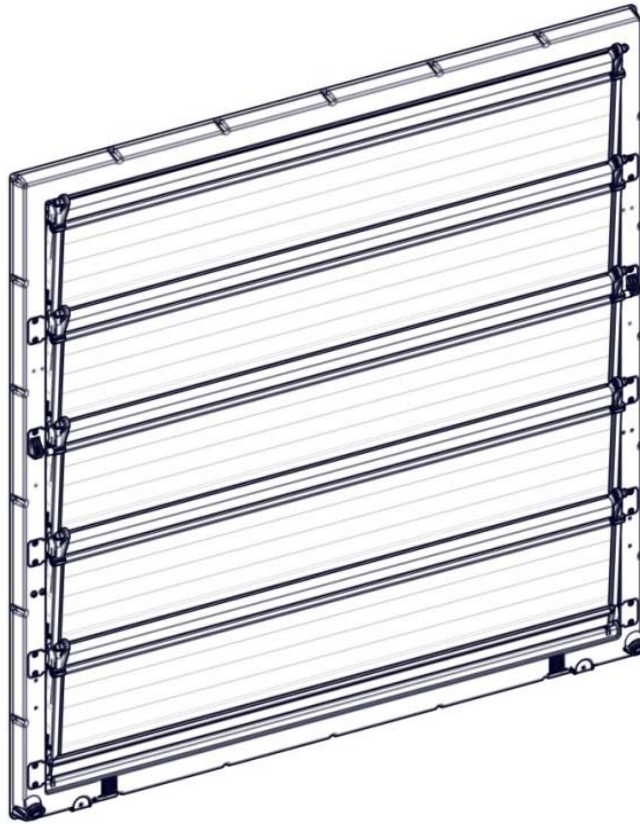

Figure 3: Overview drawing of DA17K tunnel inlet without assembly parts

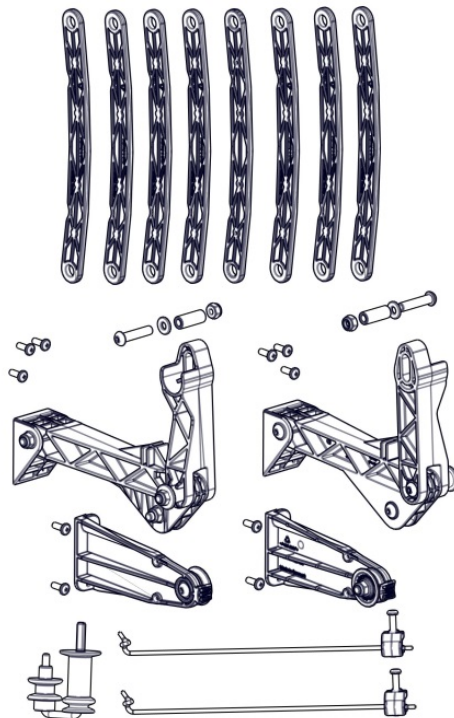
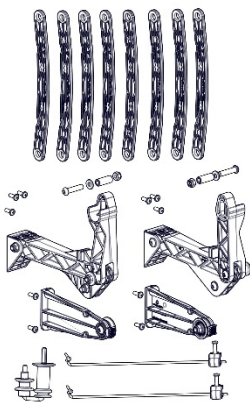
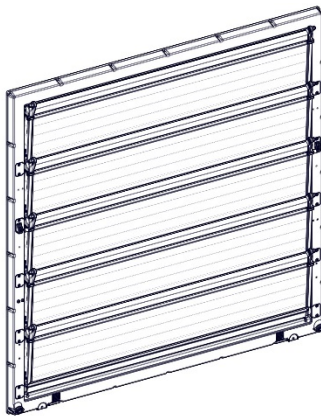

Figure 4: Overview drawing of tunnel inlet assembly parts

DA 17K tunnel inlet



433700 DA 17K tunnel inlet, high-insulated

DA 17K is used for installation in walls where insulation is necessary.

The mounting parts are used for assembling the DA 17K.

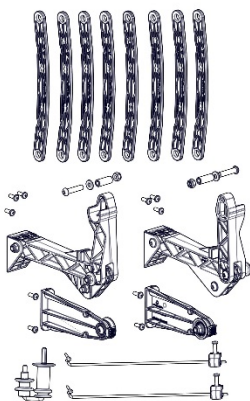
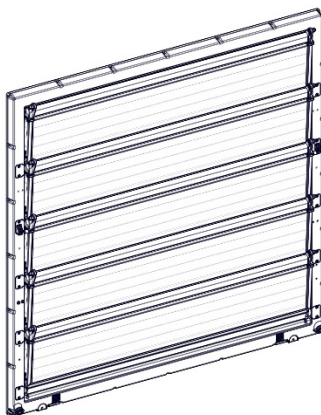

433701 DA 17K tunnel inlet, semi-insulated

DA 17K is used for installation in walls where insulation is not necessary.

The mounting parts are used for assembling the DA 17K.

DA 17K tunnel inlet accessories

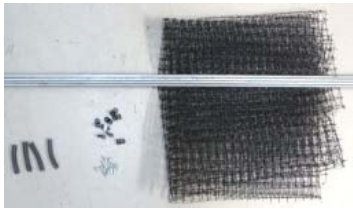

433703 DA 17K bird net

Net protects against birds.

Mask size = 20 x 16 mm.

Dimensions = 1,390 x 1,390 mm.

1 per inlet.



433702 DA 17K screw kit

Used for mounting of DA 17K tunnel inlet.

Includes 24 pcs. 4,8 x 70 mm tapping screws.

1 set per inlet.

TECHNICAL DATA

DA 17K tunnel inlet		
Performance	Without net	With net
Air output at 5 Pa [m³/h]	13.100	12.400
Air output at 10 Pa [m³/h]	18.500	17.600
Air output at 15 Pa [m³/h]	22.600	21.500
Air output at 20 Pa [m³/h]	26.100	24.800
Air output at 30 Pa [m³/h]	32.000	30.400
Mechanical		
Material high-insulated / semi-insulated	PVC	
Spring	Stainless steel	
Colour - inlet frame	RAL 7024 (grey)	
Colour - inlet flaps high-insulated / semi-insulated	RAL 9010 (white) / RAL 7035 (pale grey)	
Net size [mm]	1,390 x 1,390 with 17 x 17 masks	
Traction force [N] / [Kg]	204/ 21	
Pull length [mm]	600	
Environment		
Ambient temperature, operating		
High-insulated	-40 to + 50°C (-40 to + 122°F)	
Semi-insulated	+5 til + 50 °C (41 til + 122 °F)	
Ambient temperature, storage	-40 to +65°C (-40 to +149°F) – and protected against direct sunlight.	
Relative humidity, operating	0-95 % RH	
Shipping		
Dimensions H x W x D [mm] per layer	1600 x 1600 x 125	
Weight [kg] per piece	25	
Number of inlets per pallet	17 pieces	

Table 1: Technical data DA 17K

Dimension drawing DA 17K tunnel inlet

Dimensions expressed in mm.

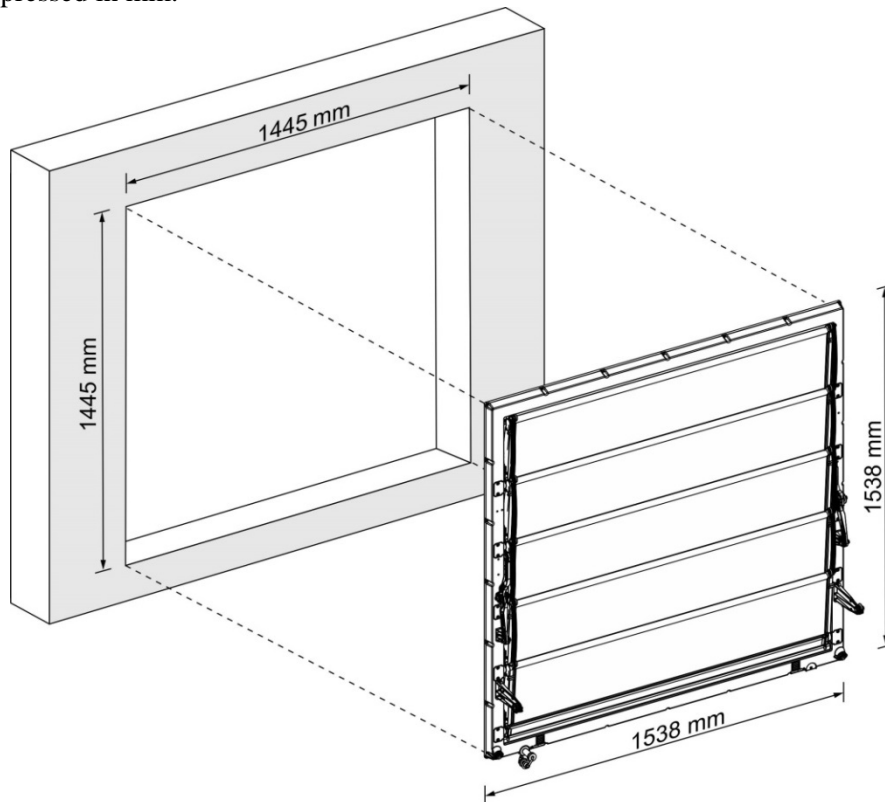

Figure 5: Dimensions for the DA 17K hole

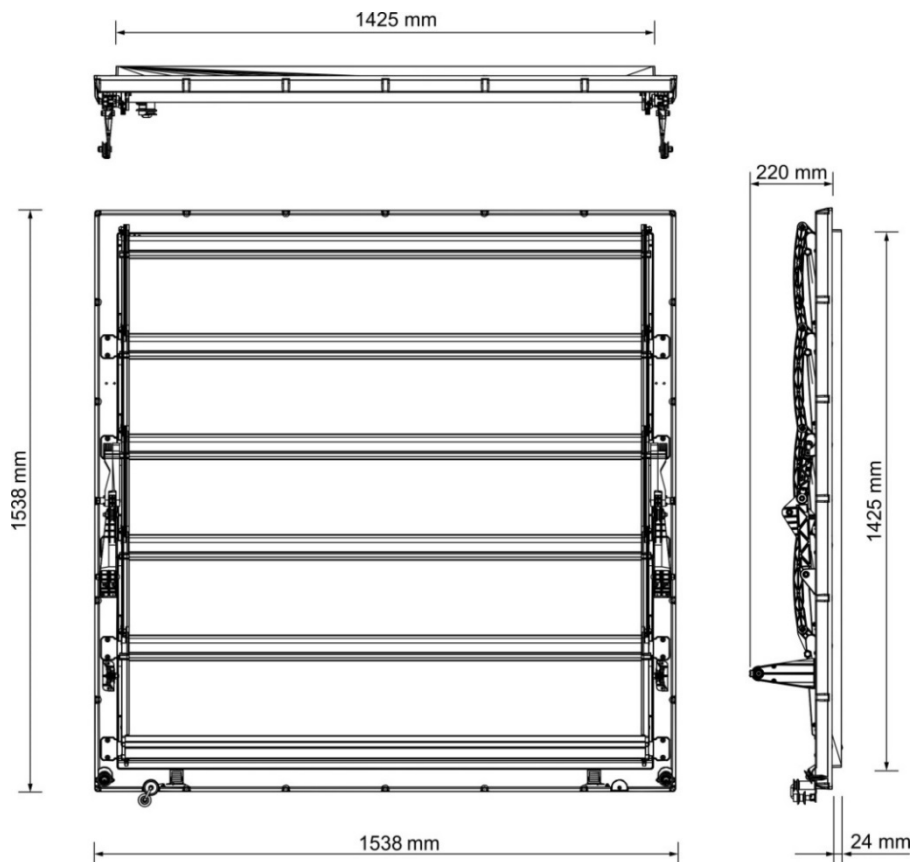

Figure 6: Dimensions for DA 17K

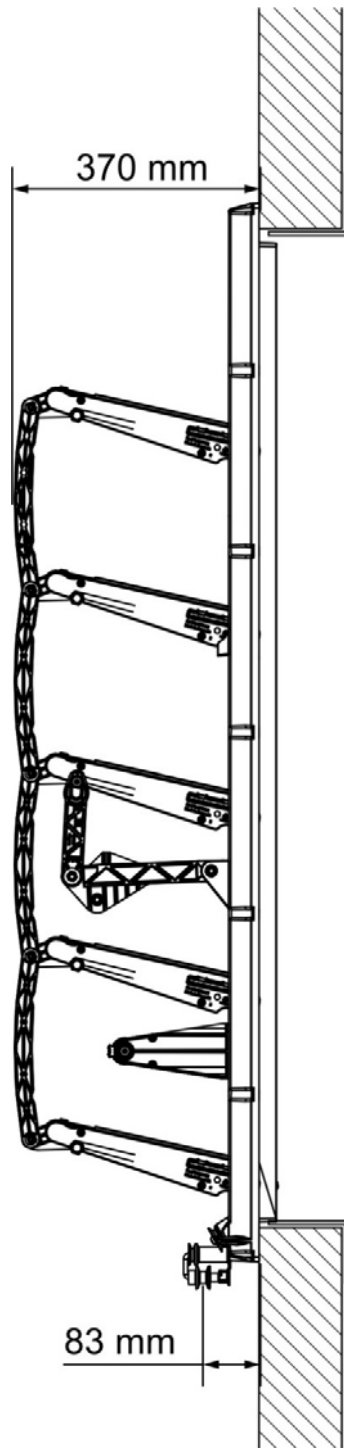

Figure 7: Dimensions for DA 17K from the side with wall.

